

Adore Properties (Stockton)

Adore Properties (Stockton)

United Kingdom

T: 01642 205023

E: stockton@adoreproperties.co.uk

W: <http://www.adoreproperties.co.uk>



Our Ref:	173224
For Sale:	£149,950
Current Status:	Sold STC
Property Type:	Bungalow
No of Bedrooms:	2
Address:	46, Grisedale Crescent, Stockton-On-Tees, Cleveland, TS16 9DT

Features

- Two Bedrooms
- Semi Detached
- Bungalow
- Garden
- Garage & Driveway
- Popular Egglescliffe location
- Gas Central Heating

Summary

Adore Properties are pleased to present this 2 double bedroom, semi-detached bungalow - situated in a quiet cul de sac within the ever so popular Egglescliffe village. The property briefly comprises of a generous size living room, fitted kitchen, two double bedrooms and a family bathroom. Further benefits to the property are an easy to maintain garden, driveway and garage. The property requires updating and has been priced to reflect condition. Offered with no chain. Adore Properties advise an early viewing!

Particulars

Adore Properties are pleased to present this 2 double bedroom, semi-detached bungalow - situated in a quiet cul de sac within the ever so popular Egglescliffe village. The property briefly comprises of a generous size living room, fitted kitchen, two double bedrooms and a family bathroom. Further benefits to the property are an easy to maintain garden, driveway and garage. The property requires updating and has been priced to reflect condition. Offered with no chain. Adore Properties advise an early viewing!

Entrance Hall

Living Room

11' 3" x 16' 5" (3.42m x 5.01m)

Kitchen

8' 10" x 9' 10" (2.70m x 2.99m)

Bathroom

5' 6" x 6' 4" (1.66m x 1.93m)

Bedroom 1

11' 3" x 12' 11" (3.42m x 3.93m)

Bedroom 2

8' 10" x 8' 11" (2.70m x 2.71m)

Photos

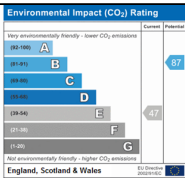
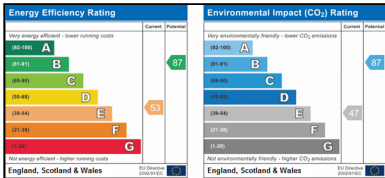

Floorplan

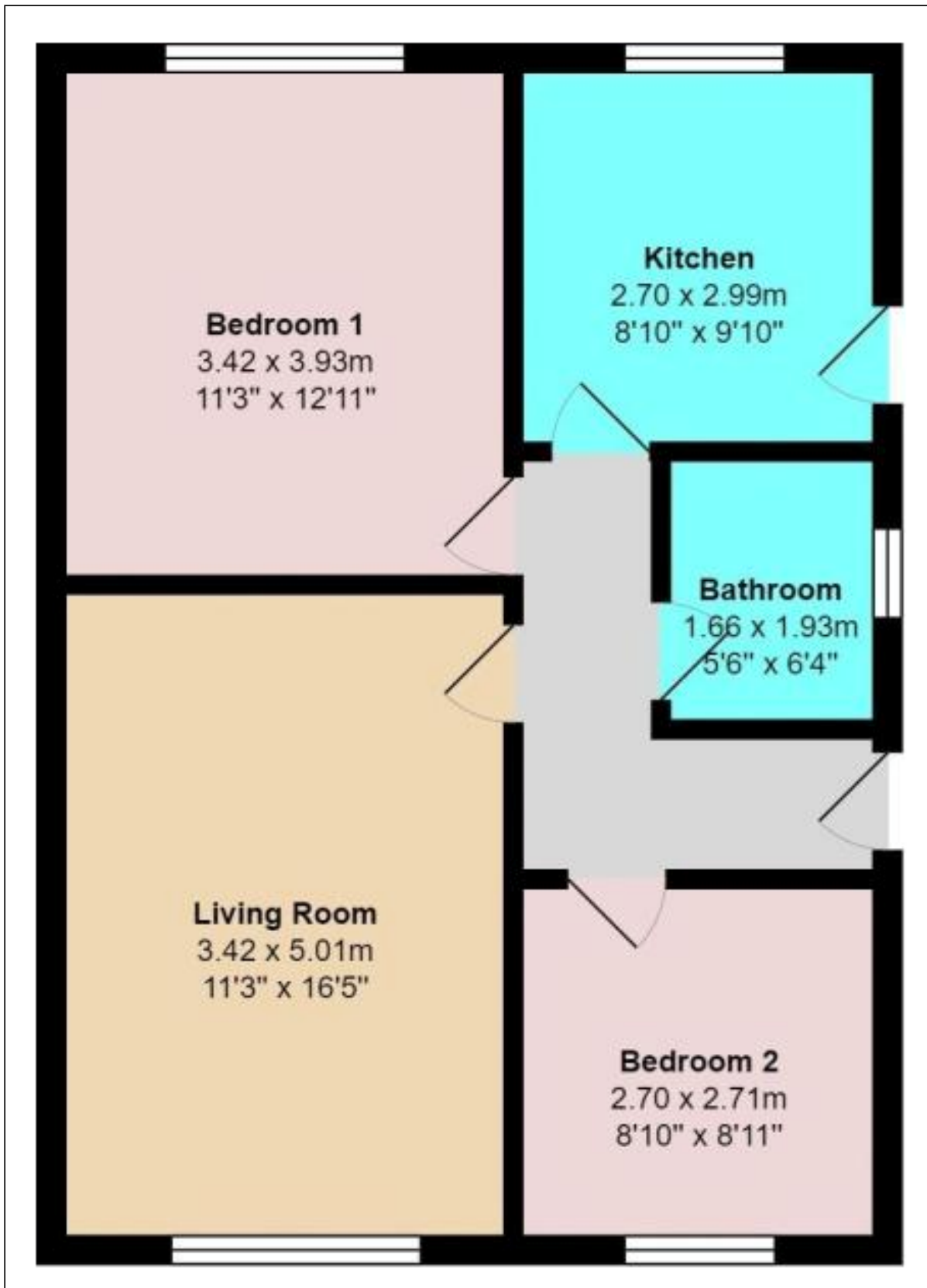

Disclaimer

All Properties

All appliances, apparatus, equipment, fixtures and fittings listed in these details are only 'as seen' and have not been tested by Adore Properties, nor have we sought certification of warranty or service, unless otherwise stated. It is in the buyer's or renter's interests to check the working condition of all appliances. Any floor plans and/or measurements provided are given as a general guide to room layout and design only. They are supplied for guidance only - they are not exact and must not be relied upon for any

purpose, and therefore must be considered incorrect. As a potential buyer or future tenant you are advised to recheck the measurements before committing to any expense. These details are offered on the understanding that all negotiations are to be made through this company. Neither these particulars, nor verbal representations, form part of any offer or contract, and their accuracy cannot be guaranteed. Adore Properties has not sought to verify the legal title of the property and any buyer or future tenant must obtain verification from their solicitor or at least be satisfied prior to contract.